

How to assign a warehouse to a customer in HDPOS smart?

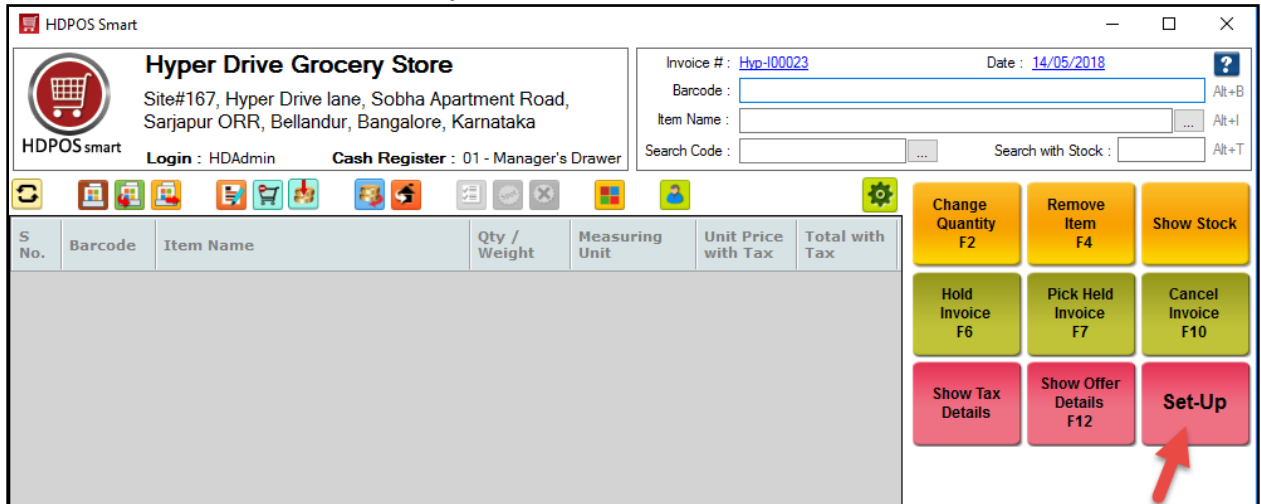

To assign a warehouse to a customer, follow the steps below:

1. Run **HDPOS smart**. Click on the **Set-Up** button from the main invoice screen.



2. From **Set-Up** screen, click on 4th page and select **Settings**.



3. From **System Setting** screen, click on **General** setting.

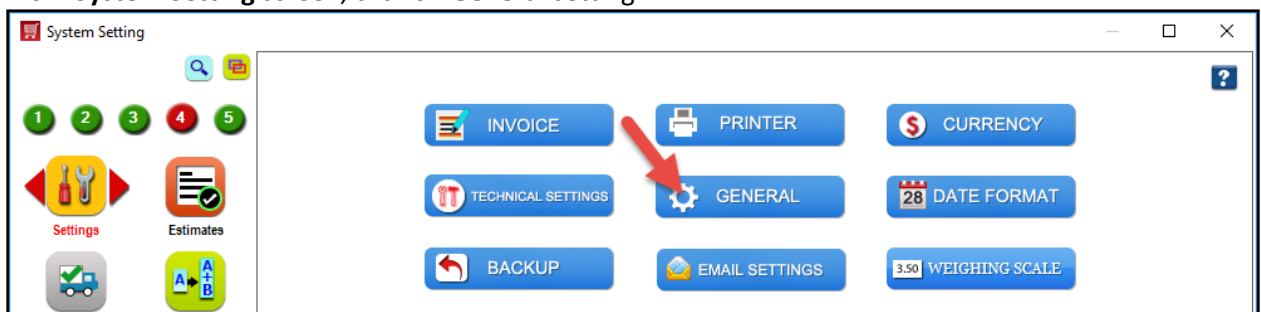



- From **General Settings** screen, click on **All Documents** tab and check the checkbox '**Allow to associate Customer with Warehouse**' under **Customer Definition** section.
- Click on **Apply**.

General Setting

Application Item Definition **All Documents** Label Stock Transfer Customer Item GST

Validations and Warnings

- Show Purchase Return Warning For Wrong Supplier
- Show Warning of Negative Stock While Doing Stock Transfer
- Made By Is Compulsory In Make & Break
- Customer Is Compulsory For Exchange

Customer Definition

Phone Number Length : 10 [Update Existing Customer Database](#)

- Keep Focus on Mobile Textbox for Customer
- Allow To Associate Customer With Warehouse**

Default Credit Limit for Customers : 0

Delay To Search Customer For Billing and Payment (In Millisecond) : 500

GRN

- Allow to Add Discount in GRN with No Effect on Purchase Price
- Allow to Pay Additional Charges in GRN to Supplier

Round off

Round off amount to nearest : 0.01

- In case of Round off difference, give preference to Item Price Before Tax

Regional Language Font Setting : Verdana, 8.25, style=Regular

[Change Font](#)

Payment Receipts

Number of Receipts Payment to Print : 1

- Show Returnable Amount PopUp

Sales Return Settings

Allow Sales Return from Invoices of last : 0 days

Purchase Return Settings

- Allow Negative Stock In Purchase Return

Penalty

- Consider Penalty in Credit Limit
- Consider Fractional Days In Penalty Calculation

Issued Cheque

- Issued Checks are Cleared Manually

Loyalty Point And Store Credit

- Show Combined Loyalty Points From All Companies
- Show Combined Store Credit From All Companies

Specify Order To Scan From Barcode

Peripheral

- Using Fiscal Printer
- Use Attached Camera

[Apply](#) [Cancel](#)

- From 1st page of **Set-Up**, select **Customer**.

Set-Up

1 2 3 4 5

Items GRN

Manage Stock Transfer Stock

Cash Registers Sales Invoices

Customers Receive Payne...

Welcome to Set-Up

Please make your selection from the left side





7. Create a new customer by clicking on **Add Customer**  button. Enter the required details and click on **Save**.

Add New Customer

Customer Code : C00009 Define my own Code

Customer Details

First Name : Srujana
Last Name : k

Is Active

Search Code :
Birth Date : Clear
Anniversary Date : Clear

VAT No : CST No :
TIN No : PAN No :
GST No :
 Is UIN Holder

Shipping Address **Billing Address**

Address Line 1 :
Address Line 2 :
City :
State :
Zip Code :
Country :

Telephone Number Mobile Number
E Mail
GST No :
Place of Supply :

Customer Loyalty

Is Enrolled For Loyalty Points
Loyalty Number : Auto-Generate Number
Enrollment Date : ...
Loyalty Points : 0.00
Referred By : (For Loyalty Points) ...
 Is Loyalty Points to Referrer on Every Invoice

Credit Limit / FA

Use System Default Credit Limit
Credit Limit : 0.00
FA Balance : 0.00

Financial Account

Business Location : Hyper Drive Grocery Store ...
Created By : ...
Customer Since Date : ...
Customer Group : ...
Financial Account
Opening Balance : 0.00 Cr Change

GST Details

Is Composition Taxable Person

Customer Display Name
Customer Name For Display : Srujana k Name by Template

User Field List

Attachments Customer Fields

Save (F8) **Cancel**

8. From 2nd page of **Set-Up**, select **Warehouses**. Click on Add Warehouse.

Manage Warehouse

Show Active Warehouse only Show Inactive Warehouse only
 Show Only Warehouse Associated With Customer Show All

Search ! ->

Business Location Name	Warehouse Name	Is Default Warehouse	Is Used For Stock Correction	Is Active	Description	Customer
Hyper Drive Grocery Store	Hyper Drive Grocery Store	Yes	No	Yes	Default Godown	
Hyper Drive Grocery Store	Hyper Drive Grocery Store-Stock Correction	No	Yes	Yes	Stock Correction Godown	
	Indiranagar Warehouse	No	No	Yes	Warehouse at Indiranagar	
	Koramangala Warehouse	No	No	Yes	Warehouse at Koramangala	

Warehouses **Item Locations**
Cheques **Transfer Cash**
Financial Acco... **Financial Trans...**





9. Enter the **Warehouse name**. Select the **Customer** and click on **Save**.

Add New Warehouse

Warehouse Name : Srujana Warehouse

Description :

Customer : Srujana k

Is Active

Save (F8) Cancel

10. You can see the Warehouse name and associated customer as shown below.

Manage Warehouse

Show Active Warehouse only Show Inactive Warehouse only

Show Only Warehouse Associated With Customer Show All

Business Location Name	Warehouse Name	Is Default Warehouse	Is Used For Stock Correction	Is Active	Description	Customer
	Srujana Warehouse	No	No	Yes		Srujana k
	Koramangala Warehouse	No	No	Yes	Warehouse at Koramangala	
	Indiranagar Warehouse	No	No	Yes	Warehouse at Indiranagar	

11. Go to 1st page and select **Transfer Stock**. Click on **Add Stock Transfer** to transfer some stock to the customer's Warehouse.

Stock Transfer

Show Only Stock Transfer Show Only Dump Stock Correction

Show Only Stock Correction Show Only Stock Transfer Request

Number	From Warehouse	To Warehouse	Employee	Comment	Stock Transfer Type	Date
Hyp-ST00002	Hyper Drive Grocery Store	Koramangala Warehouse	Srikar Alvala		STOCK TRANSFER	26/07/2017 04:55 PM
Hyp-ST00001	Hyper Drive Grocery Store	Indiranagar Warehouse	Srihari Vemula		STOCK TRANSFER	20/07/2017 07:54 PM





10. Enter the details for **stock transfer**.

- Select **From Warehouse**.
- Select **To Warehouse** as the warehouse that is associated with the customer.
- Add the Items that you want to transfer and enter its quantity.
- Click on **Save**.

Warehouse To Warehouse Stock Transfer

Select Business Location : Hyper Drive Grocery Store

Stock Transfer Number : [Hyp-ST00003](#) Date : 14/05/2018 Do Not Show Negative Stock Warning Message

Barcode : _____ From Warehouse : Hyper Drive Grocery Store Add All Items

Item Name : _____ To Warehouse : Srujana Warehouse Warehouse Associated to customer

Search Code : _____ Received By : _____

Keep Focus on Last Added Item Show Images Email : Support@hyperdriveit.com Send Email

S No.	Barcode	Search Code	Item Name	Transfe Qty / Weight	Sales Measur Unit	Available Quantity	Note	Catego
1	T00011		24 Letter Mantra Organic Multigrain Flakes	10.00	Qty	87.00		Brea...
2	T00037		24 Letter Mantra Rice Flour 1 Kg	10.00	Qty	46.00		Staples
3	T00048		Aashirvad Aata with Multigrains	10.00	Qty	50.00		Staples
4	T00080		Amul Pasturised Butter 100g	7.00	Qty	11.00		Milk P...
5	T00070		Comfort Fabric Conditioner Lily Fresh	10.00	Qty	65.00		Hair ...
6	T00076		Fresho Gram Green, 200 gm	10.00	Qty	43.00		Veget...

Change Quantity F2 Search Item F3 Remove Item F4 Barcode F6 Item Grid F9

Total Stock Quantity : 57.00

Hold & Print Hold (F7) Save & Print (F5) Save (F8) Cancel

11. From the **Manage Stock** module, go to **Customer's warehouse** and check for stock, you can see the items and quantity as below.

Manage Stock

List of Warehouses

Do Not Show Stock Correction Warehouses

Search ! ->

Business Location Name	Warehouse Name
	Srujana Warehouse
	Koramangala Warehouse
	Indiranagar Warehouse
Hyper Drive Grocery Store	Hyper Drive Grocery Store-Stock Correction
Hyper Drive Grocery Store	Hyper Drive Grocery Store

Warehousewise Item Stock

Show only items to be reordered

Show Inactive items only

Show Negative stock only

Show Stock Expiring from _____ to _____ Days

Do not Show Zero Stock Show Images

Search ! ->

Barcode	Name	Quantity	Sales Measuring Unit	Search Code
T00011	24 Letter Mantra Organic Multigrain Flakes	10	Qty	
T00037	24 Letter Mantra Rice Flour 1 Kg	10	Qty	
T00048	Aashirvad Aata with Multigrains	10	Qty	
T00080	Amul Pasturised Butter 100g	7	Qty	
T00070	Comfort Fabric Conditioner Lily Fresh	10	Qty	
T00076	Fresho Gram Green, 200 gm	10	Qty	





- 12. Go back to the main screen, select the **Customer** for whom the Warehouse was associated. Now you will be able to select only the items that are transferred to the Customer's warehouse.
- 13. Enter the items and change the quantity (if required) and click on **Pay Now**.

Hyper Drive Grocery Store
 Site#167, Hyper Drive lane, Sobha Apartment Road,
 Sarjapur ORR, Bellandur, Bangalore, Karnataka

Invoice #: Hyd-100023 Date: 14/05/2018

S No.	Barcode	Item Name	Qty / Weight	Measuring Unit	Unit Price with Tax	Total with Tax
1	T00011	24 Letter Mantra Organic Multigrain Flakes	1	Qty	149.00	149.00
2	T00070	Comfort Fabric Conditioner Lily Fresh	1	Qty	315.00	315.00
3	T00080	Amul Pasturised Butter 100g	2	Qty	40.00	80.00

Total : 544.00

Discount Amount : 0.00
 Quantity Total : 4

Customer: Srujana k

Sales Executive : _____

Pay Now (F8)

- 14. Enter the **Amount Received** and click on **Save Invoice**.

Pay Now

Invoice Number : Hyd-100023 Invoice Date : 14/05/2018

Customer Info: Customer: Srujana k Sales Executive : _____

Invoice Info: Total Before roundoff : 544.00 Quantity Total : 4
 Roundoff Amount : 0.00 Number of Items : 3
 Total : 544.00 Discount Included : 0.00 Tax Included : 67.35

Tax Details:
 CGST@2.5 : 3.55
 CGST@9 : 30.13
 SGST@2.5 : 3.55
 SGST@9 : 30.13

Payment Detail: Pending Amount: 0.00
Cash : 544.00

Amount Received : 544.00

Total Received Amount : 544.00
 Returnable Balance : 0.00

Save Invoice (F8)

